

Grundfos Multi-stage centrifugal pump stainless steel DN35 DIN flange 2,5A 400VAC type CRI 1-23 A FGJ I V HQQV (7039667)



GRUNDFOS® 

TECHNICAL SPECIFICATIONS

Material	stainless steel
----------	-----------------

Shaft	stainless steel 316
-------	---------------------

Pump body	stainless steel 316
-----------	---------------------

Material impeller 1	stainless steel 304
---------------------	---------------------

Connection	DIN flange
------------	------------

Voltage	400VAC
---------	--------

Max. temperature	90 °C
------------------	-------

Minimum medium temperature -20 °C
(continuous)

Temperature range	-20°C - 90°C
-------------------	--------------

Maximum ambient temperature 40 °C

Minimum ambient temperature	0 °C
-----------------------------	------

Type	CRI 1-23 A FGJ I V HQQV
------	-------------------------

Output Power	1.5 HP
--------------	--------

Size	DN35
------	------

Power	1.1 kW
-------	--------

Impellers	23
-----------	----

MWC	140
Ampere	2,5 A
Max flow rate	2.4 m ³ /h
Efficiency	82,7 %
Press	35
Motor RPM	2770

DIMENSIONS

L	250 mm
H-1	899 mm
W-1	210 mm
ØDi-1	35 mm
ØDi-2	35 mm
Cb-1	75 mm
Cb-2	75 mm

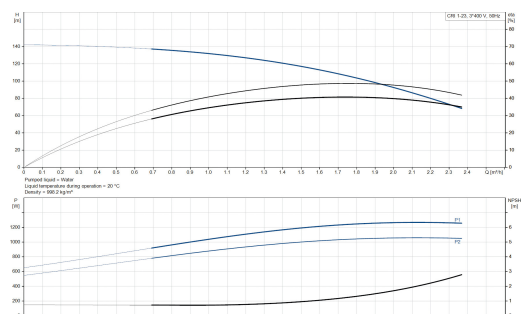
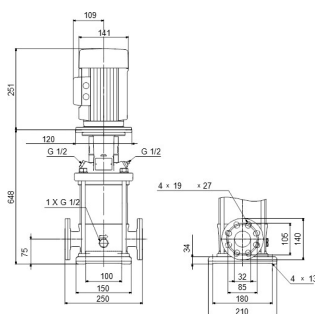

PRODUCT INFORMATION

Grundfos CRI pumps are vertical, non-self-priming, multistage, in-line, centrifugal pumps for installation in pipe systems and mounting on a foundation, suitable for industrial applications. This design provides a more compact pump design and pipework. CR pumps are designed for a variety of applications ranging from the pumping of potable water to the pumping of chemicals. The pumps are therefore suitable for a wide range of pumping systems where the performance and material of the pump meet specific demands.

Last modified date: 09/11/2025

Bosta UK Ltd.
Reflection House
Olding Road
Bury St. Edmunds
Suffolk
IP33 3TA
T +44 (0) 1284 716580
E enquiries@bosta.co.uk
<http://www.bosta.com>