

**Profec Ball valve ductile cast
iron GGG40 varnished DN150
DIN flange 16bar blue PN10/16
(0401606)**



TECHNICAL SPECIFICATIONS

Colour	blue
Material	ductile cast iron GGG40
Surface treatment	varnished
Operation	lever
Colour lever	red
Handle material	steel
Housing construction	2-part
Material housing	cast iron GG 25
Material seal	PTFE
Connection	DIN flange
Temperature range	-10°C - 100°C
Pressure	16 bar
Size	DN150
Flange	PN10/16
PCD	240 mm
Bolt hole	22 mm
Holes	8

DIMENSIONS

Ct-1 243 mm

Handle height 204

L 210 mm

PCD 240 mm

R 560 mm

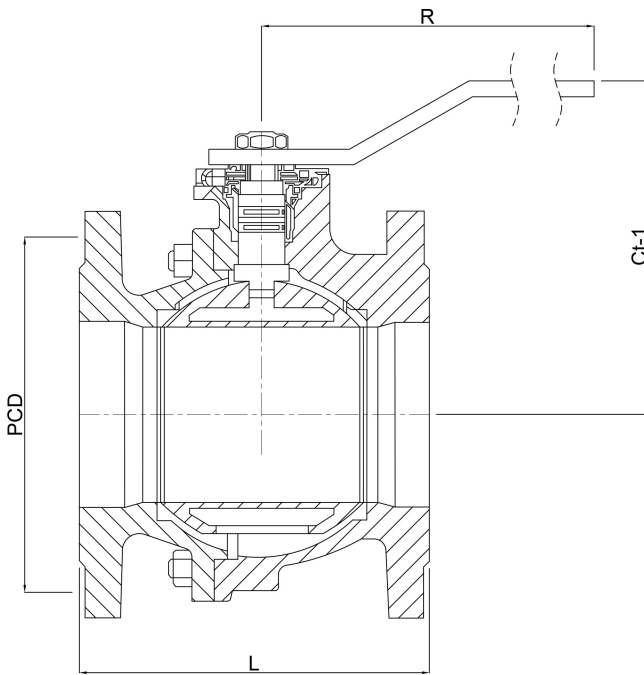

Last modified date: 21/02/2026

Bosta UK Ltd.
Reflection House
Olding Road
Bury St. Edmunds

Suffolk
IP33 3TA
T +44 (0) 1284 716580
E enquiries@bosta.co.uk
<http://www.bosta.com>