

# Hayward Pool pump 63 mm glue socket 5,9A 230VAC black type RS II VSTD 1.5HP (7016710)



 **HAYWARD®**

# TECHNICAL SPECIFICATIONS

Colour	black
Type	RS II VSTD
Pump body	PP GF
Material impeller 1	noryl
Material cover	polycarbonate
Material seal	stainless steel 304
Connection	glue socket
Voltage	230VAC
Max. temperature	35 °C
Width	234 mm
Weight	14.5 kg
Height	305 mm
Frequency	50 Hz
Max. pool vol.	100 m <sup>3</sup>
IP value	IP55
Motor RPM	600-3000
Output Power	1,5 HP

Size 63 mm

Power 1.1 kW

Ampere 5,9 A

Max flow rate 19.7 m<sup>3</sup>/h

## DIMENSIONS

A 230 mm

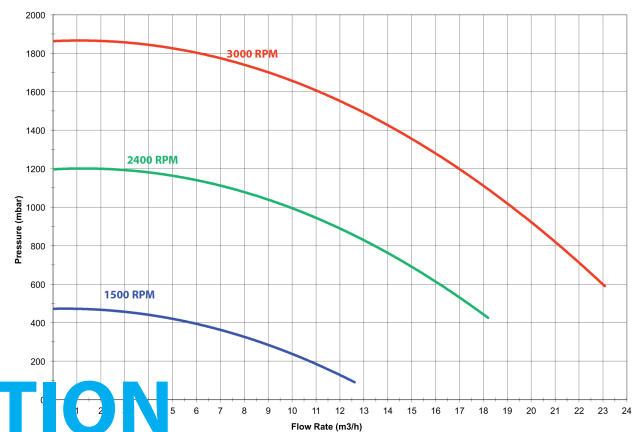
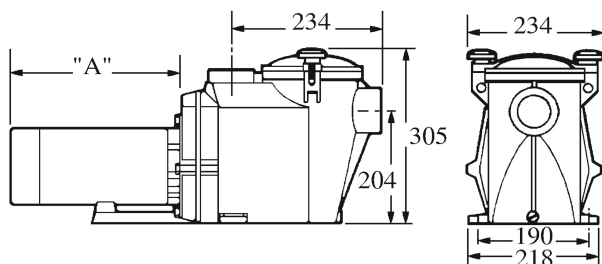

## PRODUCT INFORMATION

The RS II VSTD pump provides optimum filtration control and significant energy savings for pools of all types and sizes. Running your filtration 24 hours a day makes it possible to save up to 75% on electrical consumption. The Heavy-Duty, highly efficient, German motor offers quiet running and will give a reliable lifetime.

Features:

- Exclusive for Bevo/Bosta
- Union connection: Glue socket 63 mm
- Salt water resistant to 0.4% (4gr/ltr)
- Integrated, easy access controller with strong buttons

- 5 possible daily speed changes
- Programmable skimming function
- 4 digital inputs (dry contact) for connecting external devices
- Control box with timer function

**Last modified date: 22/02/2026**

Bosta UK Ltd.  
Reflection House  
Olding Road  
Bury St. Edmunds  
Suffolk  
IP33 3TA  
T +44 (0) 1284 716580  
E [enquiries@bosta.co.uk](mailto:enquiries@bosta.co.uk)  
<http://www.bosta.com>