

**Grundfos Variable speed
circulation pump stainless
steel 1.5" male thread 10bar
0.75A 230VAC black/red WRAS
type MAGNA3 25-60N (180)
(7039832)**



GRUNDFOS 

TECHNICAL SPECIFICATIONS

Colour black/red

Material stainless steel

Approval WRAS

Pump body stainless steel

Material impeller 1 fibreglass-reinforced PES

Connection male thread

Voltage 230VAC

Max. temperature 110 °C

Minimum medium temperature -10 °C
(continuous)

Impellers 1

Frequency 50 Hz

Maximum ambient temperature 40 °C

Pressure 10 bar

Minimum ambient temperature 0 °C

Type MAGNA3 25-60N (180)

MWC 6 m

Size

1.5"

Ampere

0.75 A

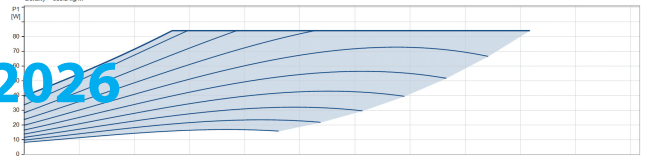
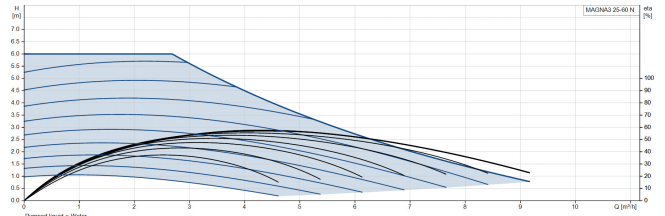
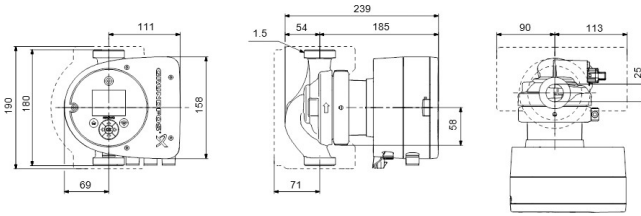

Last modified date: 09/05/2026

Bosta UK Ltd.
Reflection House
Olding Road
Bury St. Edmunds
Suffolk
IP33 3TA
T +44 (0) 1284 716580
E enquiries@bosta.co.uk
<http://www.bosta.com>