

# Kripsol Pool pump 50 mm glue socket 3,8A 230VAC black type KSE 75 M 0.75HP (7009820)



**KRIPSOL**<sup>®</sup>

# TECHNICAL SPECIFICATIONS

Colour	black
Pump body	PP GF
Material impeller 1	noryl
Material seal	stainless steel 316
Connection	glue socket
Max. temperature	50 °C
Frequency	50 Hz
IP value	IP55
Max working pressure	2,5 bar
Packaging dimensions L/W/H	650 x 255 x 330 mm
Motor RPM	2850
Type	KSE 75 M
Capacity	11,5 m <sup>3</sup> /h
Output Power	0,75 HP
Max. head	16 m
Size	50 mm
Length	550 mm

Voltage 230VAC

Weight 13.5 kg

Power 0.55 kW

Ampere 3,8 A

Noise level 59.6 dB

## DIMENSIONS

A 550 mm

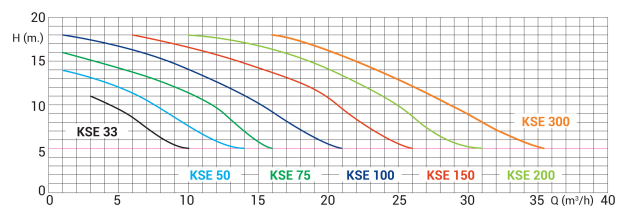
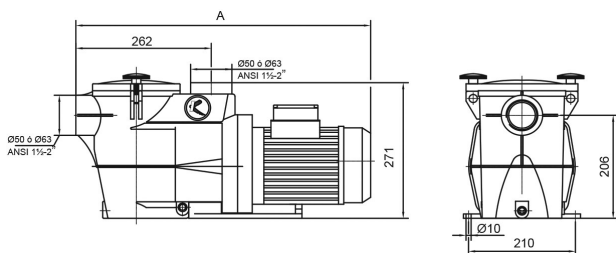

## PRODUCT INFORMATION

The Kripsol Koral KSE is an optimised and super-silent pump which is suitable for residential pools up to 177 m<sup>3</sup>

Features:

- Connection: incl 50mm or 60mm slip unions
- Visibility internal prefilter, easy access
- Corrosion-resistant & Noryl impeller
- Double drain, easy opening
- Suitable for use in salt water

**Last modified date: 12/06/2026**

Bosta UK Ltd.  
Reflection House  
Olding Road  
Bury St. Edmunds  
Suffolk  
IP33 3TA  
T +44 (0) 1284 716580  
E [enquiries@bosta.co.uk](mailto:enquiries@bosta.co.uk)  
<http://www.bosta.com>