

**Profec Hose tail 2/3 union
adaptor elbow 90° brass 1/2" x
10 mm female threaded nut x
hose tail type flat seal
(0423360)**



TECHNICAL SPECIFICATIONS

Type	flat seal
Material	brass
Material seal	EPDM
Connection	female threaded nut x hose tail
Max. temperature	120 °C
Max. temp.	120 °C
Size	1/2" x 10 mm

DIMENSIONS

Cb-1	40 mm
Cb-2	24.7 mm
F-1	8 mm
Hn	8.3 mm
P-1	25 mm
ØDi-1	1/2 "
ØDo-2	10 mm
β	90 °

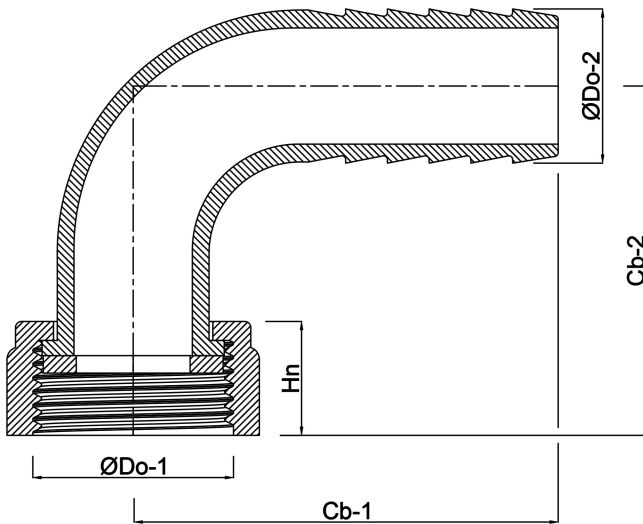

Last modified date: 21/02/2026

Bosta UK Ltd.
Reflection House
Olding Road
Bury St. Edmunds
Suffolk
IP33 3TA
T +44 (0) 1284 716580
E enquiries@bosta.co.uk
<http://www.bosta.com>